

1 BASEMENT ELECTRICAL PLAN  
SCALE: 1/4"=1'-0"

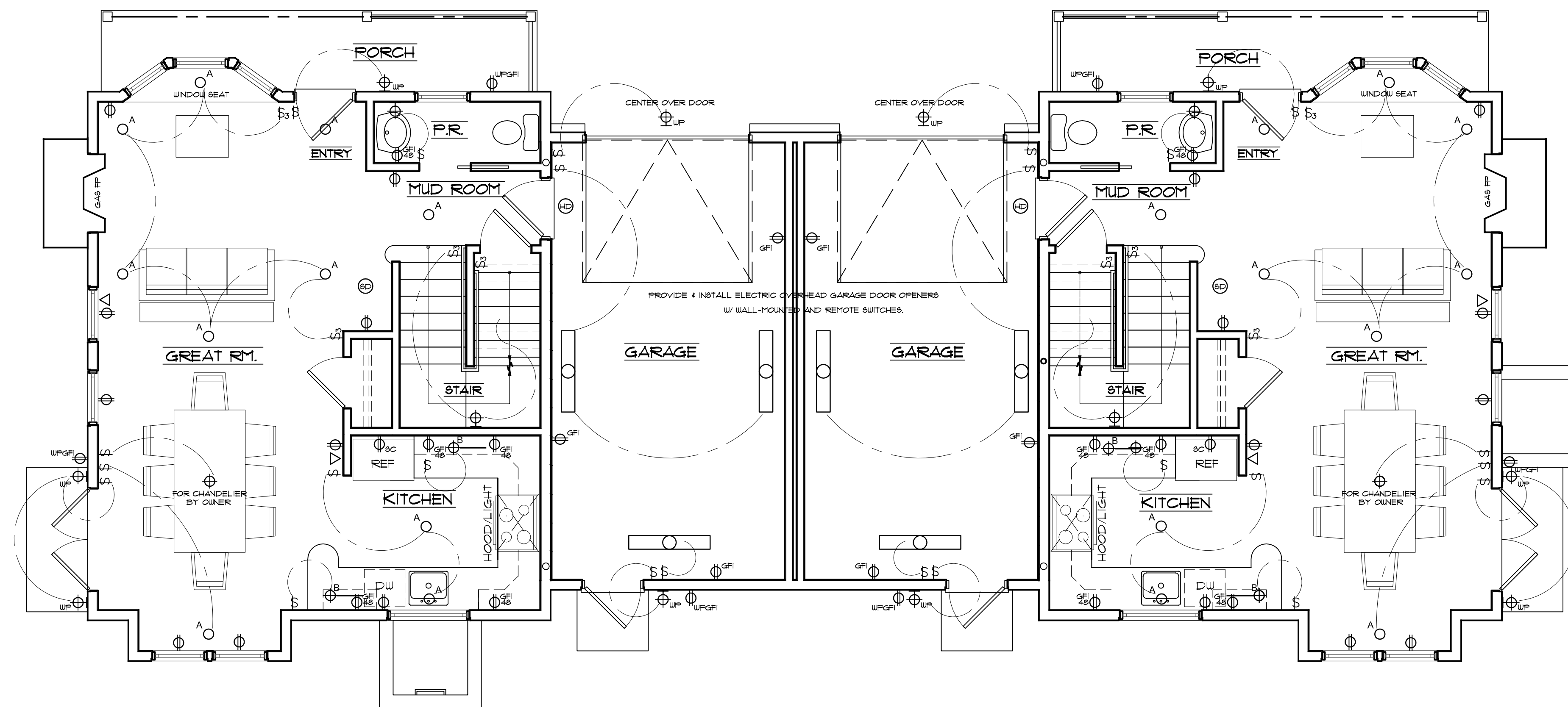

2 FIRST FLOOR ELECTRICAL PLAN  
SCALE: 1/4"=1'-0"

LEGEND

- A LIGHTOLIER LYTEPOINT 300X SERIES RECESSED DOWNLIGHT (MODEL #304B4X) BLACK ALZAK CONE, WHITE FLANGE, I.C. FRAME-IN KIT, 50W MR-16 LAMP
- B LIGHTOLIER TASKMASTER 1 FLUORESCENT DOWNLIGHT MOUNTED UNDER CABINET
- C LIGHTOLIER LYTEPOINT 300X SERIES RECESSED SHOWER LIGHT (MODEL #316U4X) WHITE FLANGE, I.C. FRAME-IN KIT, 50W MR-16 LAMP, GFCI CIRCUIT
- D PANASONIC WHISPER LITE CEILING MOUNTED FAN/LIGHT COMBINATION (MODEL #V-07VGL3) WHITE FLANGE, 13 WATT FLUORESCENT LAMP, GFCI CIRCUIT
- E SURFACE-MOUNTED COMPACT FLUORESCENT COORDINATE WITH OWNER
- F LIGHTOLIER PAR RING TRACK FIXTURE (MODEL #220AZ) W/ WALL WASHER ACCESSORY MATTE WHITE
- WALL SCONCE FURNISHED BY OWNER INSTALLED BY ELECTRICIAN
- JUNCTION BOX FOR OWNER SUPPLIED FIXTURE INSTALLED BY ELECTRICIAN
- GENERAL PURPOSE FLUORESCENT STRIP FIXTURE
- PANASONIC WHISPER CEILING FAN (MODEL #V-08VQ2) WHITE FLANGE, GFCI CIRCUIT
- DUPLX WALL OUTLET MOUNTED 12" AFF.
- DUPLX WALL OUTLET MOUNTED AT HEIGHT INDICATED IN INCHES AFF.
- GFI GROUND FAULT INTERRUPTER
- CABT DUPLX OUTLET MOUNTED IN CABINET
- SC DEDICATED OUTLET FOR EQUIPMENT OR APPLIANCE, MOUNTED 12" AFF, UNO.
- SW STANDARD DUPLX OUTLET W/ 1 PLUG SWITCHED, MOUNTED 12" AFF, UNO.
- WPF WEATHER PROOF DUPLX OUTLET MOUNTED 12" AFF, UNO.
- SM HARD-WIRED SMOKE DETECTOR W/ BATTERY BACK-UP
- SH HARD-WIRED HEAT DETECTOR W/ BATTERY BACK-UP
- SD HARD-WIRED CARBON MONOXIDE DETECTOR W/ BATTERY BACK-UP
- TELEPHONE OUTLET MOUNTED 12" AFF.
- CTV CABLE TV OUTLET MOUNTED 12" AFF.
- S SINGLE POLE SWITCH MOUNTED 48" AFF.
- S3 THREE-WAY SWITCH MOUNTED 48" AFF.
- SL SINGLE POLE SWITCH W/ PILOT LIGHT MOUNTED 48" AFF, UNO.
- PLUMBING FIXTURE SCHEDULE SEE DRAWING #

NOTES

- 1) COORDINATE EXACT LOCATION OF FIXTURES, OUTLETS, CONTROLS, ETC., W/ OWNER
- 2) PROVIDE SMOKE DETECTORS AS PER CODE
- 3) ALL DOWNLIGHTS TO BE DIMMER CONTROLLED LUTRON SKYLARK OR EQUAL

1	01/14/05	FOR CONSTRUCTION
NO.	DATE	ISSUE

PROJECT  
**SALEM WOODS - BLDG. "A"**  
282 & 284 BRUCE PARK AVE.  
GREENWICH, CT

DRAWING TITLE  
**BASEMENT & FIRST FLR.  
ELECTRICAL PLANS**

**RIDBERG + Associates**  
Ridberg & Associates,  
Architects, PC  
20 Church Street, Suite A4  
Greenwich, CT 06830  
203 625 0491  
203 625 0621 (FAX)  
www.ridarch.com

DATE	December 1st, 2004	DWG NO	
SCALE	1/4"=1'-0"	<b>BLDG. "A"</b>	
DRAWN BY	JRP	<b>E1.0</b>	
PROJECT NO.	04054		

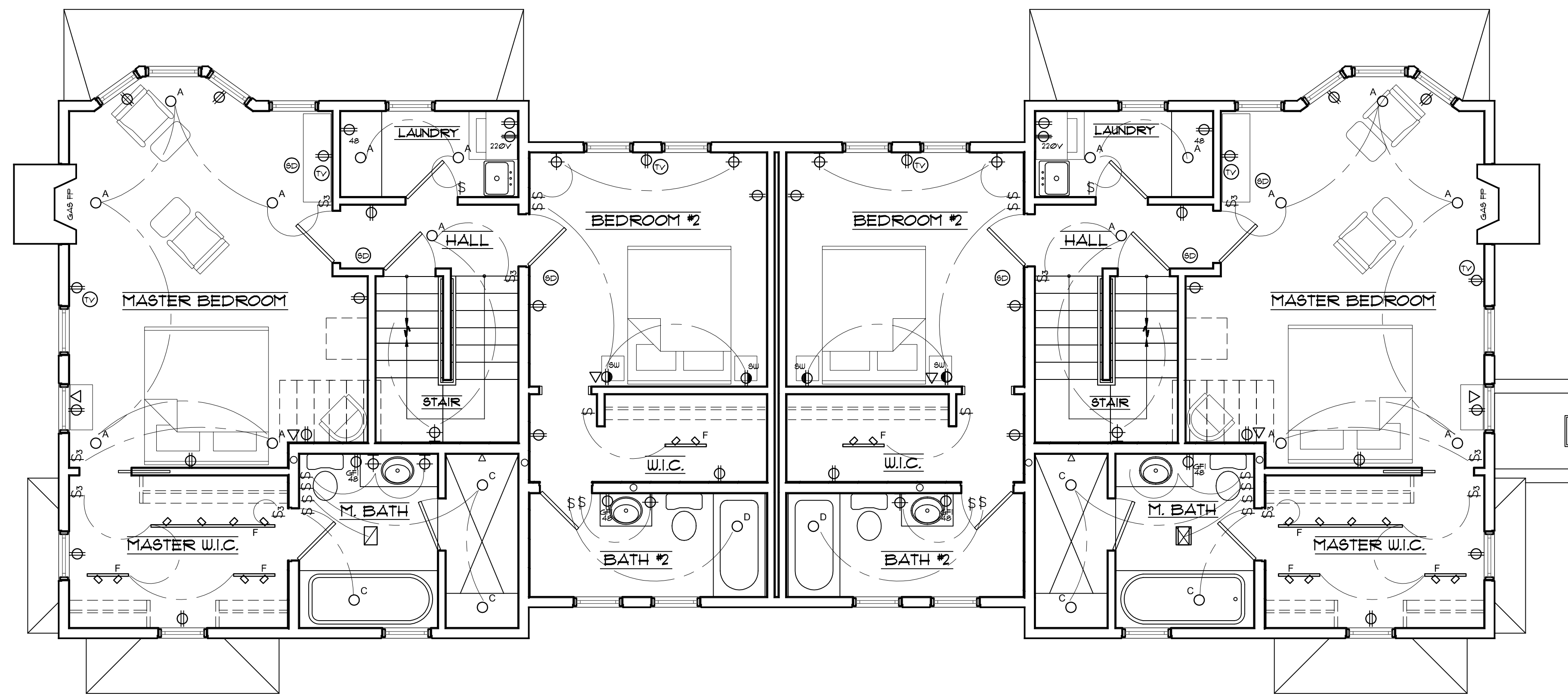

1 SECOND FLR. ELECTRICAL PLAN  
SCALE: 1/4"=1'-0"

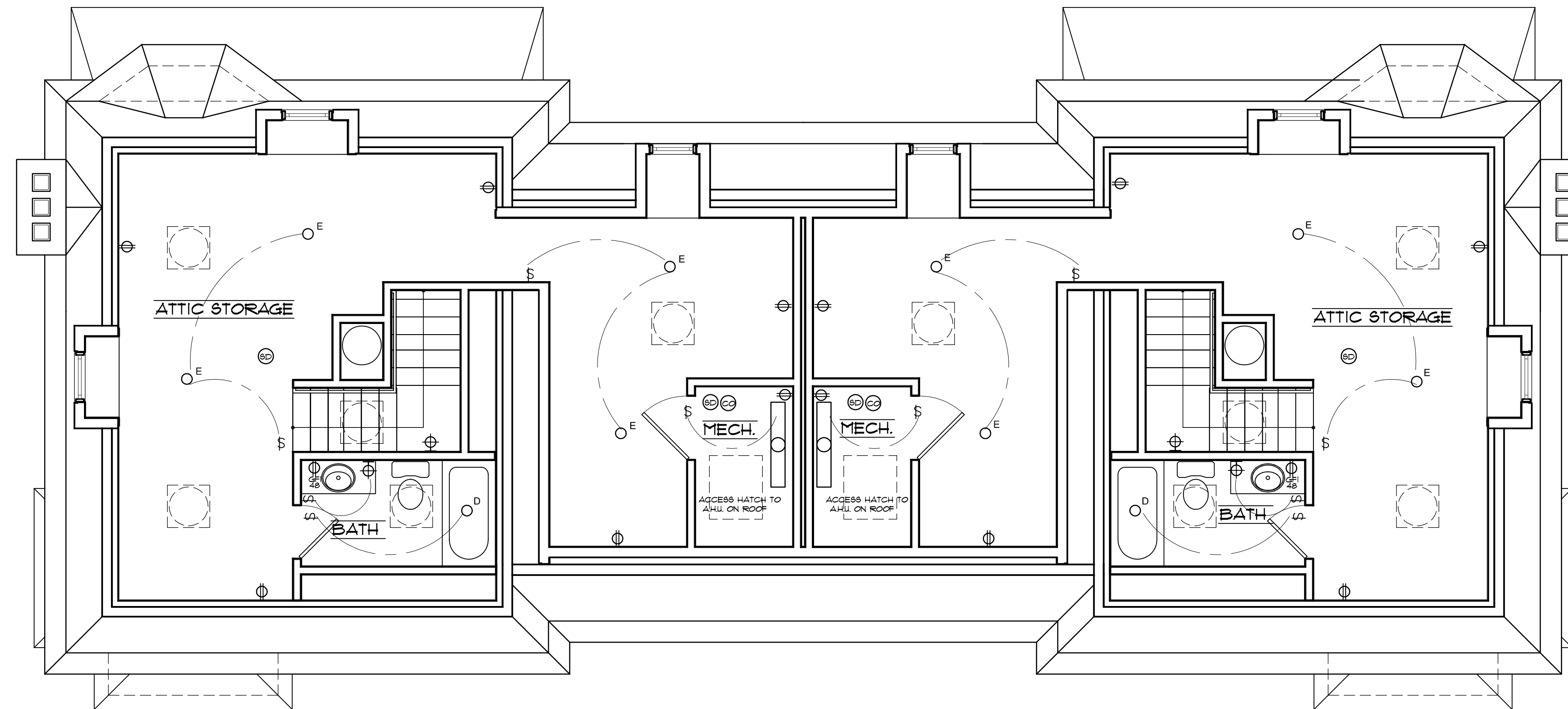

2 ATTIC ELECTRICAL PLAN  
SCALE: 1/4"=1'-0"

LEGEND	
⊙ A	LIGHTOLIER LYTEPOINT 300X SERIES RECESSED DOWNLIGHT (MODEL #304BAX) BLACK ALZAK CONE, WHITE FLANGE, I.C. FRAME-IN KIT, 50W MR-16 LAMP
⊙ B	LIGHTOLIER TASKMASTER 1 FLUORESCENT DOWNLIGHT MOUNTED UNDER CABINET
⊙ C	LIGHTOLIER LYTEPOINT 300X SERIES RECESSED SHOWER LIGHT (MODEL #316UHX) WHITE FLANGE, I.C. FRAME-IN KIT, 50W MR-16 LAMP, GFCI CIRCUIT
⊙ D	PANASONIC WHISPER LITE CEILING MOUNTED FAN/LIGHT COMBINATION (MODEL #V-07VGL3) WHITE FLANGE, 13 WATT FLUORESCENT LAMP, GFCI CIRCUIT
⊙ E	SURFACE-MOUNTED COMPACT FLUORESCENT
⊙ F	LIGHTOLIER FAR RING TRACK FIXTURE (MODEL #2280AZ) W/ WALL WASHER ACCESSORY MATTE WHITE
⊙	WALL SCONCE FURNISHED BY OWNER INSTALLED BY ELECTRICIAN
⊙	JUNCTION BOX FOR OWNER SUPPLIED FIXTURE INSTALLED BY ELECTRICIAN
⊙	GENERAL PURPOSE FLUORESCENT STRIP FIXTURE
⊙	PANASONIC WHISPER CEILING FAN (MODEL #V-08VQ2) WHITE FLANGE, GFCI CIRCUIT
⊙	DUPLEX WALL OUTLET MOUNTED 12" AFF.
⊙	DUPLEX WALL OUTLET MOUNTED AT HEIGHT INDICATED IN INCHES AFF.
⊙	GROUND FAULT INTERRUPTER
⊙	DUPLEX OUTLET MOUNTED IN CABINET
⊙	DEDICATED OUTLET FOR EQUIPMENT OR APPLIANCE, MOUNTED 12" AFF, UNO.
⊙	STANDARD DUPLEX OUTLET W/ 1 PLUG SWITCHED, MOUNTED 12" AFF, UNO.
⊙	WEATHER PROOF DUPLEX OUTLET MOUNTED 12" AFF, UNO.
⊙	HARD-WIRED SMOKE DETECTOR W/ BATTERY BACK-UP
⊙	HARD-WIRED HEAT DETECTOR W/ BATTERY BACK-UP
⊙	HARD-WIRED CARBON MONOXIDE DETECTOR W/ BATTERY BACK-UP
⊙	TELEPHONE OUTLET MOUNTED 12" AFF.
⊙	CABLE TV OUTLET MOUNTED 12" AFF.
⊙	SINGLE POLE SWITCH MOUNTED 48" AFF.
⊙	THREE-WAY SWITCH MOUNTED 48" AFF.
⊙	SINGLE POLE SWITCH W/ PILOT LIGHT MOUNTED 48" AFF, UNO.
⊙	PLUMBING FIXTURE SCHEDULE SEE DRAWING #

NOTES	
1)	COORDINATE EXACT LOCATION OF FIXTURES, OUTLETS, CONTROLS, ETC., W/ OWNER
2)	PROVIDE SMOKE DETECTORS AS PER CODE
3)	ALL DOWNLIGHTS TO BE DIMMER CONTROLLED LUTRON SKYLARK OR EQUAL

NO.	DATE	ISSUE
1	01/14/05	FOR CONSTRUCTION

PROJECT  
**SALEM WOODS - BLDG. "A"**  
 282 & 284 BRUCE PARK AVE.  
 GREENWICH, CT  
 DRAWING TITLE  
**SECOND FLR. & ATTIC ELECTRICAL PLANS**

**RIDBERG + Associates**  
 Ridberg & Associates,  
 Architects, PC  
 20 Church Street, Suite A4  
 Greenwich, CT 06830  
 203 625 0491  
 203 625 0621 (FAX)  
 www.ridarch.com

DATE	December 1st, 2004	DWG NO	BLDG. "A"
SCALE	1/4"=1'-0"		<b>E1.1</b>
DRAWN BY	JRP		
PROJECT NO.	04054		